

**Parts List:**

- A - Wood Seat (1 pc)
- B - Center Screw Pole (1 pc)
- C - "L" Legs (4 pcs)
- D - Inner Footrest Ring (1 pc)
- E - Outer Support Ring (1 pc)

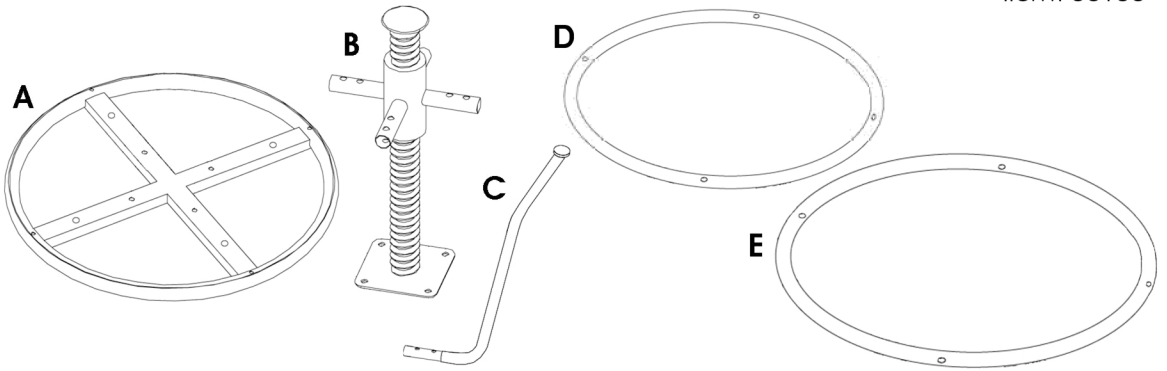

**Hardware:**

- 1/4" x 1/2" Machine Screws (16 pcs)
- 1/4" x 1-3/16" Machine Screws (4 pcs)
- 1/4" Washers (12 pcs)
- 1/4" Lock Washers (12 pcs)
- Allen Wrench (1 pc)

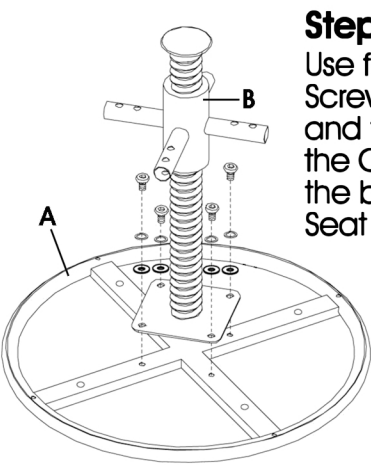
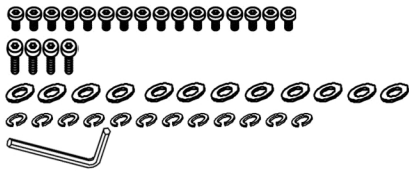

**Step 1**  
Use four *short* Machine Screws, four Lock Washers and four Washers to attach the Center Screw Pole (B) to the bottom of the Wood Seat Frame (A).

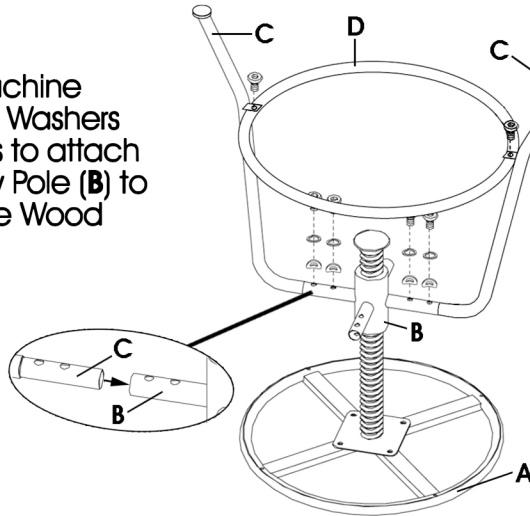

**Step 2**  
Insert two of the "L" Legs (C) into opposite side extensions of the Swivel Screw Pole (B). Secure using two *short* Machine Screws, two Lock Washers and two Washers each. Then, using two additional *short* Machine Screws, attach the Inner Footrest Ring (D) to the bottom Flanges of the Legs (C).

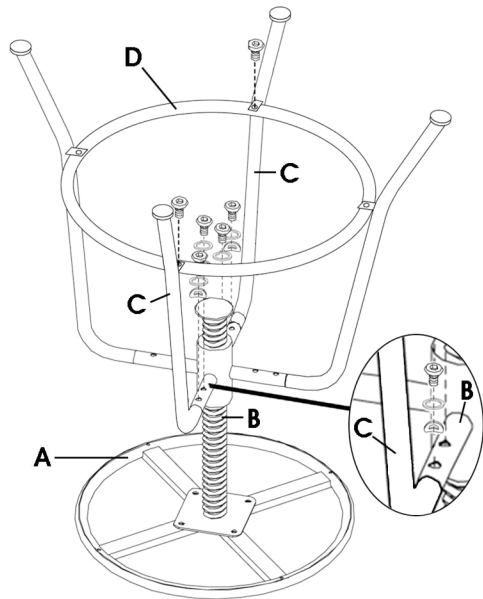

**Step 3**  
Insert the final two "L" Legs (C) into the open side extensions of the Swivel Screw Pole (B). Secure using two *short* Machine Screws, two Lock Washers and two Washers each. Then, using two additional *short* Machine Screws, attach the Inner Footrest Ring (D) to the bottom Flanges of the Legs (C).

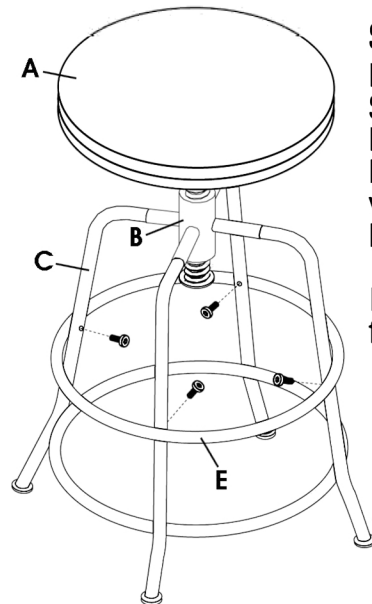

**Step 4**  
Flip the Stool upright. Slide the Outer Support Ring (E) over the "L" Legs (C) and secure with the four *long* Machine Screws.  
  
Re-tighten all Screws for your safety.

**Load Capacity**  
250 Lbs

